



itl boulder
THE LIGHT CENTER OF THE INDUSTRY SINCE 1955

INDEPENDENT TESTING LABORATORIES, INC.
3386 LONGHORN ROAD, BOULDER, CO 80302 USA

PHONE: (303)442-1255 • FAX: (303)449-5274 • E-MAIL: itl@itlboulder.com • WEBSITE: www.itlboulder.com

ISOFOOTCANDLE LINES OF HORIZONTAL ILLUMINATION

Values based on 1.61 foot mounting height.

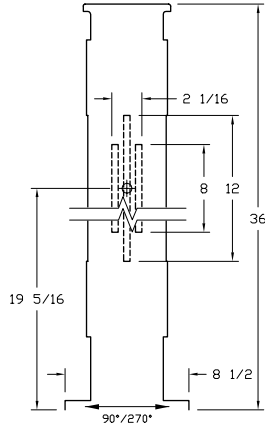

REPORT NUMBER: ITL56912
DATE: 11/18/05
PREPARED FOR: FAIRWEATHER SITE
FURNISHINGS, A DIVISION OF LEADER
MANUFACTURING, INC.
CATALOG NUMBER: B-6-L 1-PANEL LIGHTED
BOLLARD
LUMINAIRE: FABRICATED SILVER PAINTED
FOUR SIDED METAL HOUSING WITH ONE
LIGHTED PANEL ON ONE SIDE, THE
LIGHTED PANEL HAS TWO SLOTS MEASURING
APPROXIMATELY 0.4375" BY 8.0625" AND
ONE SLOT MEASURING APPROXIMATELY
0.4375" BY 12.0625". EACH SLOT
CONTAINS ONE LED ASSEMBLY INSERTED
FROM INTERIOR OF HOUSING.
LAMPS: TWO ILIGHT PN24W1-65 WHITE
LIGHT EMITTING DIODE (LED) ASSEMBLIES
MEASURING APPROXIMATELY 0.375" BY 8"
AND ONE ILIGHT PN24W1-65 WHITE LIGHT
EMITTING DIODE (LED) ASSEMBLY
MEASURING APPROXIMATELY 0.375" BY
12". EACH LED ASSEMBLY HAS A
TRANSLUCENT AMBER TINTED
SEMI-CYLINDRICAL PLASTIC DIFFUSER AND
IS MOUNTED WITH THE LONG AXIS VERTICAL.
NOTE: DATA SHOWN IS ABSOLUTE FOR THE
SAMPLE PROVIDED AT 120 VOLTS AC INPUT
TO HIGH PERFORMANCE TECH. LP1040-24
POWER SUPPLY.
TOTAL INPUT WATTS= 8.1 AT 120.0 VOLTS
IES Cutoff Classification: Noncutoff

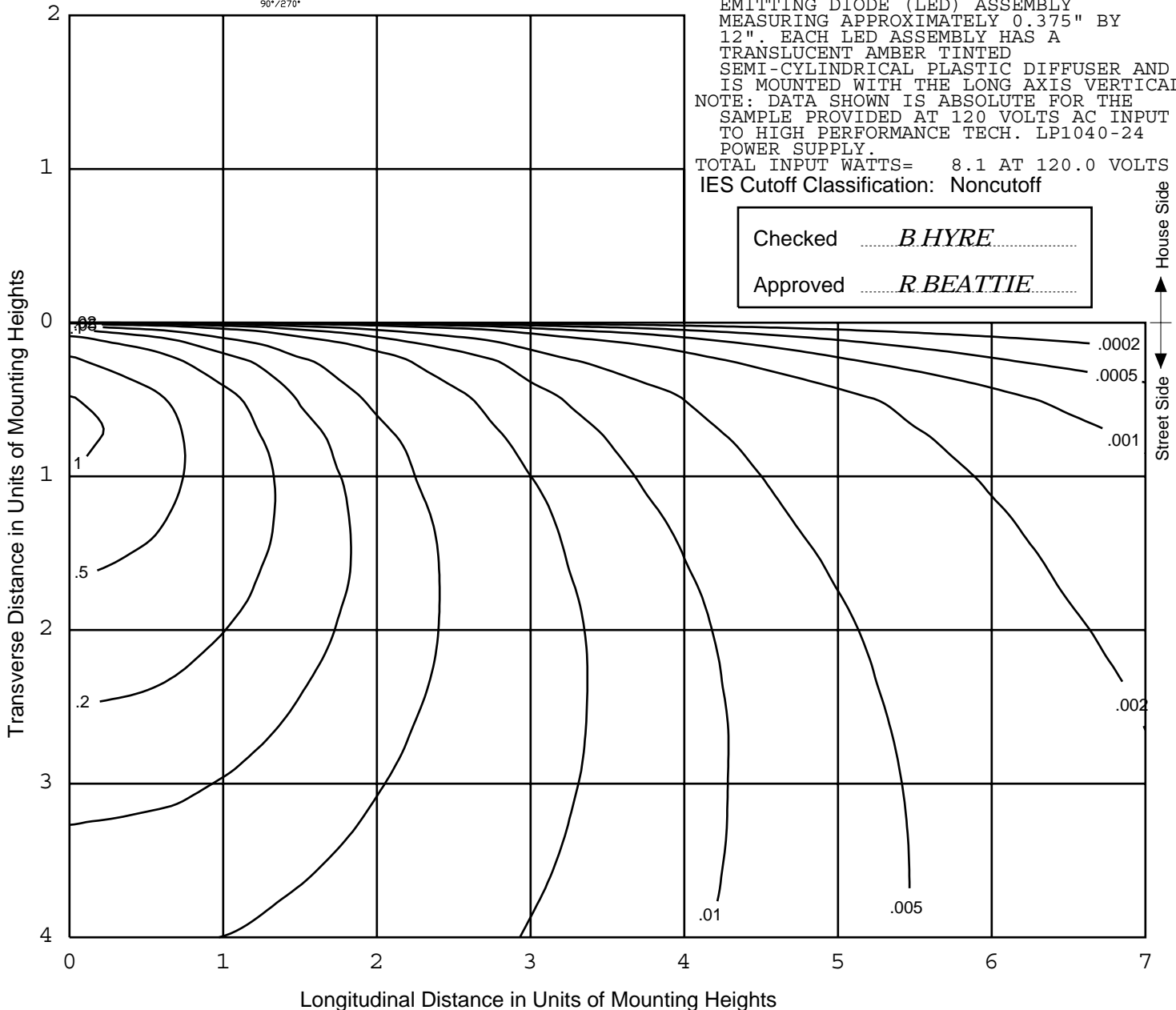

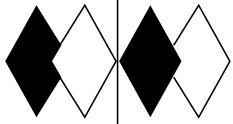

REPORT NUMBER: ITL56912
 DATE: 11/18/05
 PREPARED FOR: FAIRWEATHER SITE
 FURNISHINGS, A DIVISION OF LEADER
 MANUFACTURING, INC.
 CATALOG NUMBER: B-6-L 1-PANEL LIGHTED
 BOLLARD
 LUMINAIRE: FABRICATED SILVER PAINTED
 FOUR SIDED METAL HOUSING WITH ONE
 LIGHTED PANEL ON ONE SIDE, THE
 LIGHTED PANEL HAS TWO SLOTS MEASURING
 APPROXIMATELY 0.4375" BY 8.0625" AND
 ONE SLOT MEASURING APPROXIMATELY
 0.4375" BY 12.0625". EACH SLOT
 CONTAINS ONE LED ASSEMBLY INSERTED
 FROM INTERIOR OF HOUSING.
 LAMPS: TWO ILIGHT PN24W1-65 WHITE
 LIGHT EMITTING DIODE (LED) ASSEMBLIES
 MEASURING APPROXIMATELY 0.375" BY 8"
 AND ONE ILIGHT PN24W1-65 WHITE LIGHT
 EMITTING DIODE (LED) ASSEMBLY
 MEASURING APPROXIMATELY 0.375" BY
 12". EACH LED ASSEMBLY HAS A
 TRANSLUCENT AMBER TINTED
 SEMI-CYLINDRICAL PLASTIC DIFFUSER AND
 IS MOUNTED WITH THE LONG AXIS VERTICAL.
 NOTE: DATA SHOWN IS ABSOLUTE FOR THE
 SAMPLE PROVIDED AT 120 VOLTS AC INPUT
 TO HIGH PERFORMANCE TECH. LP1040-24
 POWER SUPPLY.
 TOTAL INPUT WATTS= 8.1 AT 120.0 VOLTS

MAXIMUM PLANE AND MAXIMUM CONE PLOTS OF CANDELA

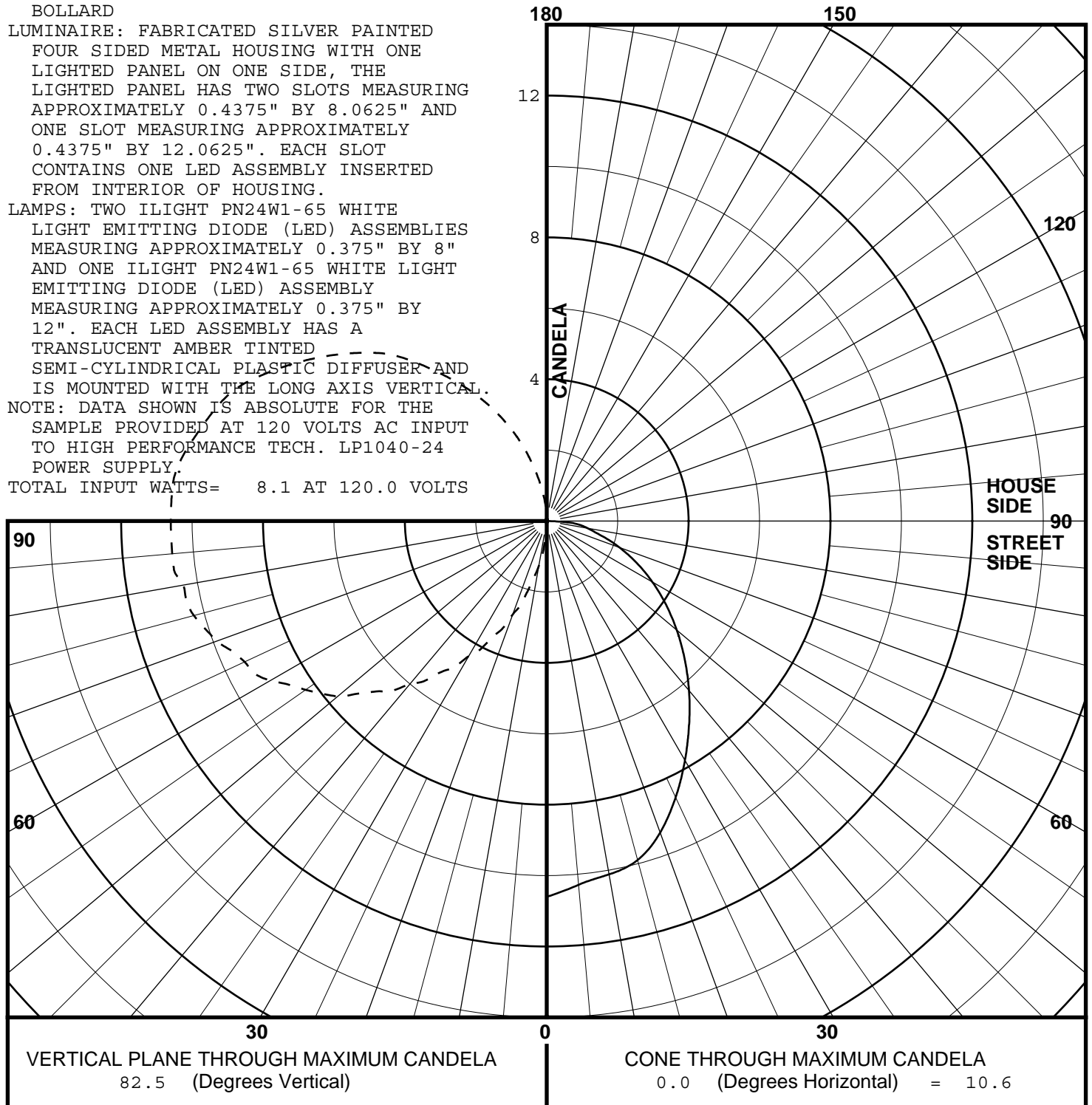



REPORT NUMBER: ITL56912 DATE: 11/18/05
 PREPARED FOR: FAIRWEATHER SITE FURNISHINGS, A DIVISION OF LEADER
 MANUFACTURING, INC.
 COEFFICIENTS OF UTILIZATION AND FLUX DISTRIBUTION

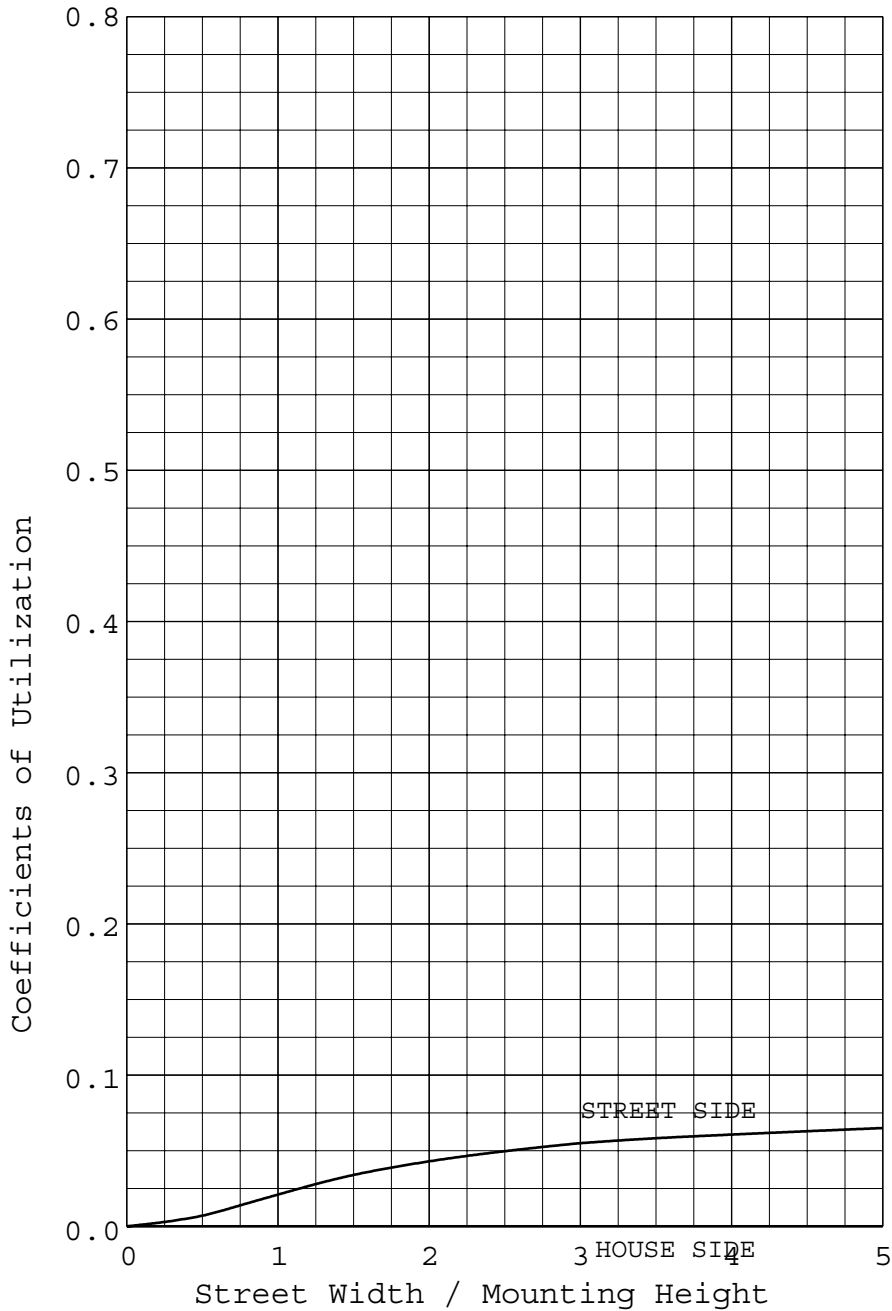

	LUMENS
DOWNWARD STREET SIDE	13
DOWNWARD HOUSE SIDE	0
DOWNWARD TOTAL	13
UPWARD STREET SIDE	13
UPWARD HOUSE SIDE	0
UPWARD TOTAL	13
TOTAL FLUX	26

ALL CANDELA, LUMENS AND COEFFICIENT OF UTILIZATION VALUES IN THIS REPORT ARE BASED ON RELATIVE PHOTOMETRY WHICH ASSUMES A BALLAST FACTOR OF 1.00. ANY CALCULATIONS PREPARED FROM THESE DATA SHOULD INCLUDE AN APPROPRIATE BALLAST FACTOR.

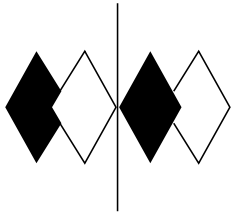

itl boulder
THE LIGHT CENTER OF THE INDUSTRY SINCE 1955

INDEPENDENT TESTING LABORATORIES, INC.
 3386 LONGHORN ROAD, BOULDER, CO 80302 USA

PHONE: (303)442-1255 • FAX: (303)449-5274 • E-MAIL: itl@itlboulder.com • WEBSITE: www.itlboulder.com

REPORT NUMBER: ITL56912 DATE: 11/18/05
 PREPARED FOR: FAIRWEATHER SITE FURNISHINGS, A DIVISION OF LEADER
 MANUFACTURING, INC.

CANDELA TABULATION

	LATERAL ANGLE											
	0.0	5.0	15.0	25.0	35.0	45.0	55.0	65.0	75.0	85.0	90.0	
180.0	0.0	0.0	0.0	0.0	0.0	0.0	0.0	0.0	0.0	0.0	0.0	
175.0	0.5	0.2	0.3	0.2	0.2	0.1	0.1	0.0	0.0	0.0	0.0	
165.0	1.8	1.6	1.6	1.5	1.2	1.0	0.7	0.4	0.2	0.0	0.0	
155.0	3.4	3.3	3.2	2.8	2.5	2.0	1.5	1.0	0.6	0.2	0.0	
145.0	5.0	4.9	4.7	4.2	3.6	2.9	2.2	1.5	0.9	0.4	0.0	
135.0	6.7	6.5	6.3	5.5	4.7	3.8	2.8	2.0	1.1	0.5	0.0	
125.0	8.0	7.9	7.6	6.6	5.5	4.4	3.3	2.3	1.3	0.6	0.0	
115.0	9.3	9.1	8.6	7.6	6.3	5.0	3.7	2.5	1.5	0.7	0.0	
105.0	10.1	9.9	9.4	8.2	6.8	5.3	3.9	2.6	1.6	0.7	0.0	
95.0	10.6	10.3	9.9	8.6	6.9	5.5	4.0	2.7	1.6	0.8	0.0	
90.0	10.6	10.4	9.9	8.6	7.1	5.5	4.0	2.8	1.6	0.8	0.0	
87.5	10.6	10.3	9.9	8.7	7.1	5.5	4.1	2.8	1.6	0.8	0.0	
85.0	10.6	10.3	9.9	8.6	7.1	5.5	4.1	2.8	1.6	0.9	0.0	
82.5 <<	10.6	10.3	9.9	8.6	7.0	5.5	4.1	2.8	1.6	0.8	0.0	
80.0	10.4	10.3	9.9	8.6	6.9	5.5	4.0	2.8	1.6	0.8	0.0	
77.5	10.4	10.2	9.8	8.4	6.9	5.5	4.0	2.8	1.6	0.8	0.0	
75.0	10.3	10.0	9.6	8.4	6.8	5.4	4.0	2.7	1.6	0.8	0.0	
72.5	10.1	9.9	9.4	8.2	6.8	5.4	3.9	2.7	1.6	0.7	0.0	
70.0	9.9	9.7	9.3	8.1	6.6	5.3	3.9	2.7	1.6	0.8	0.0	
V 67.5	9.6	9.4	9.1	7.9	6.5	5.2	3.8	2.6	1.6	0.7	0.0	
E 65.0	9.4	9.3	8.8	7.7	6.4	5.1	3.8	2.6	1.5	0.7	0.0	
R 62.5	9.3	9.1	8.6	7.5	6.3	5.0	3.7	2.5	1.5	0.7	0.0	
T 60.0	9.0	8.7	8.4	7.3	6.1	4.8	3.6	2.5	1.5	0.7	0.0	
I 57.5	8.6	8.4	8.1	7.1	5.9	4.7	3.5	2.5	1.4	0.6	0.0	
C 55.0	8.3	8.1	7.8	6.8	5.7	4.7	3.3	2.4	1.4	0.6	0.0	
A 52.5	8.0	7.7	7.4	6.5	5.5	4.4	3.3	2.3	1.4	0.6	0.0	
L 50.0	7.7	7.4	7.2	6.3	5.3	4.2	3.2	2.1	1.3	0.6	0.0	
47.5	7.2	7.0	6.8	5.9	5.0	4.1	3.1	2.1	1.2	0.6	0.0	
A 45.0	6.8	6.6	6.4	5.6	4.8	3.8	2.9	2.0	1.1	0.5	0.0	
N 42.5	6.5	6.2	6.0	5.3	4.5	3.7	2.8	2.0	1.1	0.5	0.0	
G 40.0	6.0	5.8	5.7	5.0	4.2	3.5	2.6	1.8	1.1	0.5	0.0	
L 37.5	5.7	5.4	5.2	4.7	4.0	3.3	2.5	1.6	1.0	0.4	0.0	
E 35.0	5.2	5.0	4.9	4.3	3.7	3.0	2.3	1.5	0.9	0.4	0.0	
32.5	4.9	4.6	4.5	3.9	3.3	2.8	2.1	1.4	0.8	0.3	0.0	
30.0	4.4	4.1	4.1	3.6	3.0	2.5	2.0	1.3	0.7	0.3	0.0	
27.5	4.1	3.8	3.8	3.3	2.8	2.4	1.8	1.1	0.7	0.3	0.0	
25.0	3.6	3.3	3.3	2.8	2.5	2.0	1.5	1.1	0.6	0.2	0.0	
20.0	2.8	2.5	2.5	2.1	1.9	1.5	1.1	0.7	0.5	0.2	0.0	
15.0	2.0	1.6	1.6	1.5	1.2	1.1	0.8	0.5	0.2	0.0	0.0	
10.0	1.3	0.9	1.0	0.8	0.7	0.6	0.3	0.0	0.0	0.0	0.0	
5.0	0.5	0.2	0.2	0.2	0.1	0.0	0.0	0.0	0.0	0.0	0.0	
0.0	0.0	0.0	0.0	0.0	0.0	0.0	0.0	0.0	0.0	0.0	0.0	

PLANE OF MAXIMUM CANDELA

CONE OF MAXIMUM CANDELA

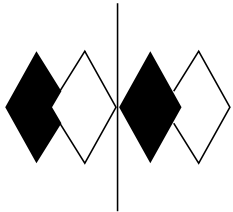

itl boulder
THE LIGHT CENTER OF THE INDUSTRY SINCE 1955

INDEPENDENT TESTING LABORATORIES, INC.
 3386 LONGHORN ROAD, BOULDER, CO 80302 USA

PHONE: (303)442-1255 • FAX: (303)449-5274 • E-MAIL: itl@itlboulder.com • WEBSITE: www.itlboulder.com

REPORT NUMBER: ITL56912 DATE: 11/18/05
 PREPARED FOR: FAIRWEATHER SITE FURNISHINGS, A DIVISION OF LEADER
 MANUFACTURING, INC.

CANDELA TABULATION

	HOUSE SIDE		LATERAL ANGLE							
	95.0	105.0	115.0	125.0	135.0	145.0	155.0	165.0	175.0	180.0
180.0	0.0	0.0	0.0	0.0	0.0	0.0	0.0	0.0	0.0	0.0
175.0	0.0	0.0	0.0	0.0	0.0	0.0	0.0	0.0	0.0	0.0
165.0	0.0	0.0	0.0	0.0	0.0	0.0	0.0	0.0	0.0	0.0
155.0	0.0	0.0	0.0	0.0	0.0	0.0	0.0	0.0	0.0	0.0
145.0	0.0	0.0	0.0	0.0	0.0	0.0	0.0	0.0	0.0	0.0
135.0	0.0	0.0	0.0	0.0	0.0	0.0	0.0	0.0	0.0	0.0
125.0	0.0	0.0	0.0	0.0	0.0	0.0	0.0	0.0	0.0	0.0
115.0	0.0	0.0	0.0	0.0	0.0	0.0	0.0	0.0	0.0	0.0
105.0	0.0	0.0	0.0	0.0	0.0	0.0	0.0	0.0	0.0	0.0
95.0	0.0	0.0	0.0	0.0	0.0	0.0	0.0	0.0	0.0	0.0
90.0	0.0	0.0	0.0	0.0	0.0	0.0	0.0	0.0	0.0	0.0
87.5	0.0	0.0	0.0	0.0	0.0	0.0	0.0	0.0	0.0	0.0
85.0	0.0	0.0	0.0	0.0	0.0	0.0	0.0	0.0	0.0	0.0
82.5 <<	0.0	0.0	0.0	0.0	0.0	0.0	0.0	0.0	0.0	0.0
80.0	0.0	0.0	0.0	0.0	0.0	0.0	0.0	0.0	0.0	0.0
77.5	0.0	0.0	0.0	0.0	0.0	0.0	0.0	0.0	0.0	0.0
75.0	0.0	0.0	0.0	0.0	0.0	0.0	0.0	0.0	0.0	0.0
72.5	0.0	0.0	0.0	0.0	0.0	0.0	0.0	0.0	0.0	0.0
70.0	0.0	0.0	0.0	0.0	0.0	0.0	0.0	0.0	0.0	0.0
V 67.5	0.0	0.0	0.0	0.0	0.0	0.0	0.0	0.0	0.0	0.0
E 65.0	0.0	0.0	0.0	0.0	0.0	0.0	0.0	0.0	0.0	0.0
R 62.5	0.0	0.0	0.0	0.0	0.0	0.0	0.0	0.0	0.0	0.0
T 60.0	0.0	0.0	0.0	0.0	0.0	0.0	0.0	0.0	0.0	0.0
I 57.5	0.0	0.0	0.0	0.0	0.0	0.0	0.0	0.0	0.0	0.0
C 55.0	0.0	0.0	0.0	0.0	0.0	0.0	0.0	0.0	0.0	0.0
A 52.5	0.0	0.0	0.0	0.0	0.0	0.0	0.0	0.0	0.0	0.0
L 50.0	0.0	0.0	0.0	0.0	0.0	0.0	0.0	0.0	0.0	0.0
47.5	0.0	0.0	0.0	0.0	0.0	0.0	0.0	0.0	0.0	0.0
A 45.0	0.0	0.0	0.0	0.0	0.0	0.0	0.0	0.0	0.0	0.0
N 42.5	0.0	0.0	0.0	0.0	0.0	0.0	0.0	0.0	0.0	0.0
G 40.0	0.0	0.0	0.0	0.0	0.0	0.0	0.0	0.0	0.0	0.0
L 37.5	0.0	0.0	0.0	0.0	0.0	0.0	0.0	0.0	0.0	0.0
E 35.0	0.0	0.0	0.0	0.0	0.0	0.0	0.0	0.0	0.0	0.0
32.5	0.0	0.0	0.0	0.0	0.0	0.0	0.0	0.0	0.0	0.0
30.0	0.0	0.0	0.0	0.0	0.0	0.0	0.0	0.0	0.0	0.0
27.5	0.0	0.0	0.0	0.0	0.0	0.0	0.0	0.0	0.0	0.0
25.0	0.0	0.0	0.0	0.0	0.0	0.0	0.0	0.0	0.0	0.0
20.0	0.0	0.0	0.0	0.0	0.0	0.0	0.0	0.0	0.0	0.0
15.0	0.0	0.0	0.0	0.0	0.0	0.0	0.0	0.0	0.0	0.0
10.0	0.0	0.0	0.0	0.0	0.0	0.0	0.0	0.0	0.0	0.0
5.0	0.0	0.0	0.0	0.0	0.0	0.0	0.0	0.0	0.0	0.0
0.0	0.0	0.0	0.0	0.0	0.0	0.0	0.0	0.0	0.0	0.0

CONE OF MAXIMUM CANDELA