

SPECIFICATIONS

MATERIAL

Wood: 10 each 1 1/2" x 2 1/2" wood elements,
All edged eased.

End Frames: Ductile cast iron end frames cast with 1/4" x 2" flange to attach wood elements. Frames shall have an arm rest flared to 2 5/8". Frames shall have a recess for hardware which attaches stretcher bar.

Center strap: 3/8" x 2" mild steel predrilled to accept hardware. All steel shall conform to ASTM A 36 hot rolled steel and shall be wheelabrated prior to fabrication.

Stretcher bar: 1" sch. 40 pipe (1-5/16" OD)

FASTENERS

Wood shall be attached to end frames and center frame with #14 stainless steel vandal resistant screws. Stretcher bar shall be attached to end frame with 3/8" x 1 1/4" SS buttonhead bolts and washers.

Anchor bolts by others.

PROTECTIVE COATINGS

Wood: clear wood preservative

Powder Coating: Following fabrication parts shall be cleaned and treated with an iron phosphate process prior to the coating application. This process shall include a non-chromated alkaline cleaner and an iron phosphate treatment followed with an acidic sealer for maximum adhesion. The protective coatings shall be either polyester or polyester TGIC powder. Following application the parts shall be baked until properly cured. The coating shall be a minimum of 4 mils thick on all surfaces.

OPTIONS

Length: 4, to 8 ft. standard, other lengths available

Center Frame or Center Arm

Wood: Western red cedar, clear vertical grain Douglas fir, Clear all heart redwood, lpe, other species available on request

Recycled Plastic-see TD-3P

Tradition Series, TD-3 Bench

FairWeather Site Furnishings

360-895-2626 or Toll Free 800-323-1798
Port Orchard, Washington

©1999-2002 Leader International Corporation,
FairWeather Site Furnishings division

SPECIFICATIONS

MATERIAL

Wood: 10 each 1 1/2" x 2 1/2" wood elements,
All edged eased.

End Frames: Ductile cast iron end frames
cast with 1/4" x 2" flange to attach wood
elements. Frames shall have an arm rest flared
to 2 5/8". Frames shall have a recess for
hardware which attaches stretcher bar.

Center strap: 3/8" x 2" mild steel predrilled
to accept hardware. All steel shall conform
to ASTM A 36 hot rolled steel and shall be
wheelabrated prior to fabrication.

Stretcher bar: 1" sch. 40 pipe (1-5/16" OD)

FASTENERS

Wood shall be attached to end frames and
center frame with #14 stainless steel vandal
resistant screws. Stretcher bar shall be
attached to end frame with 3/8" x 1 1/4" SS
buttonhead bolts and washers.

Anchor bolts by others.

PROTECTIVE COATINGS

Wood: clear wood preservative

Powder Coating: Following fabrication parts
shall be cleaned and treated with an iron
phosphate process prior to the coating
application. This process shall include a non-
chromated alkaline cleaner and an iron
phosphate treatment followed with an acidic
sealer for maximum adhesion. The protective
coatings shall be either polyester or polyester
TGIC powder. Following application the parts
shall be baked until properly cured. The coating
shall be a minimum of 4 mils thick on all surfaces.

OPTIONS

Length: 4, to 8 ft. standard, other lengths
available

decorative insert for arm

Wood: Western red cedar, clear vertical grain
Douglas fir, Clear all heart redwood, lpe, other
species available on request

Recycled Plastic-see TD-3P

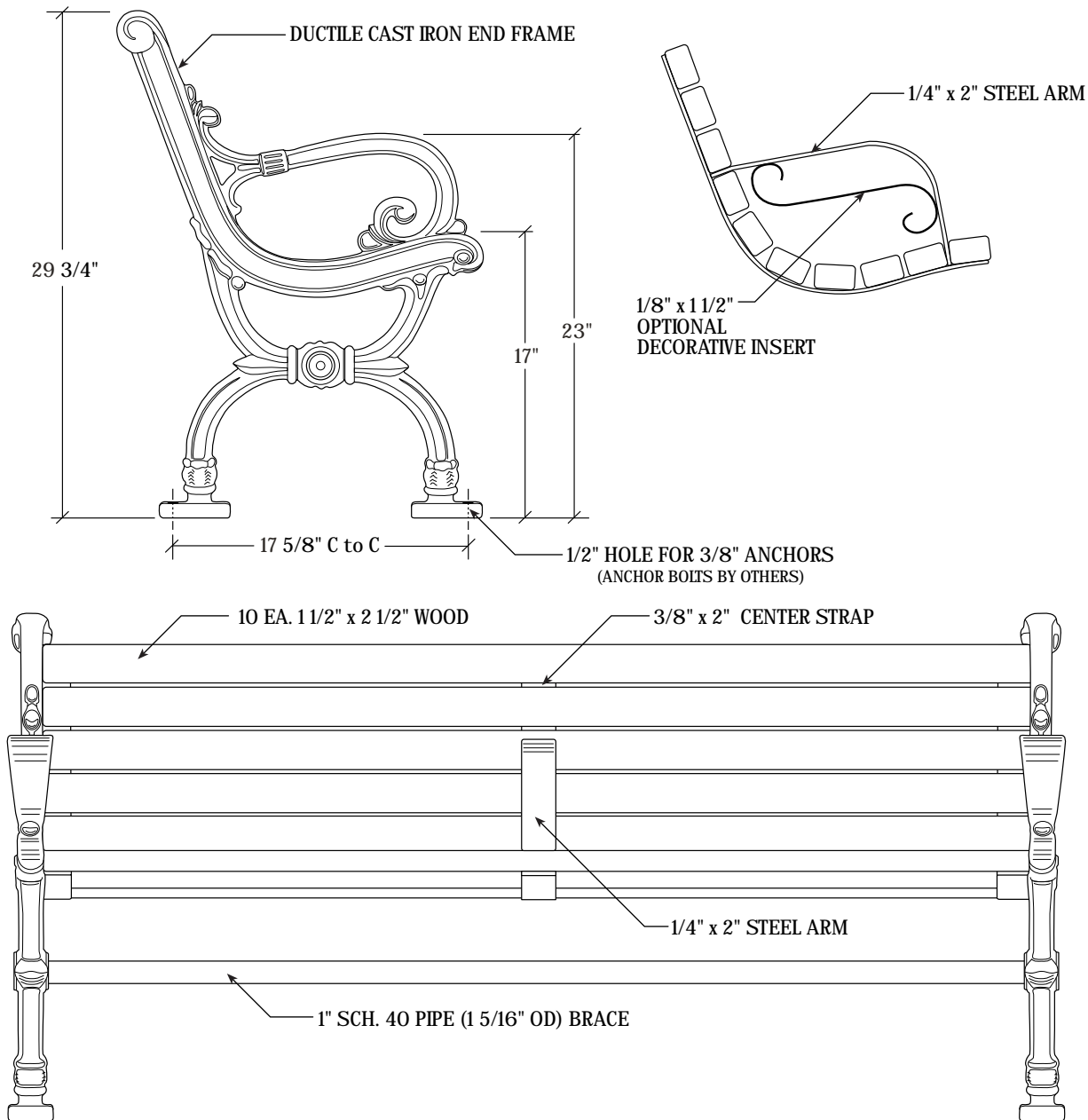

Tradition Series, TD-3 Bench with center arm

FairWeather Site Furnishings

360-895-2626 or Toll Free 800-323-1798

Port Orchard, Washington

©1999-2002 Leader International Corporation,
FairWeather Site Furnishings division

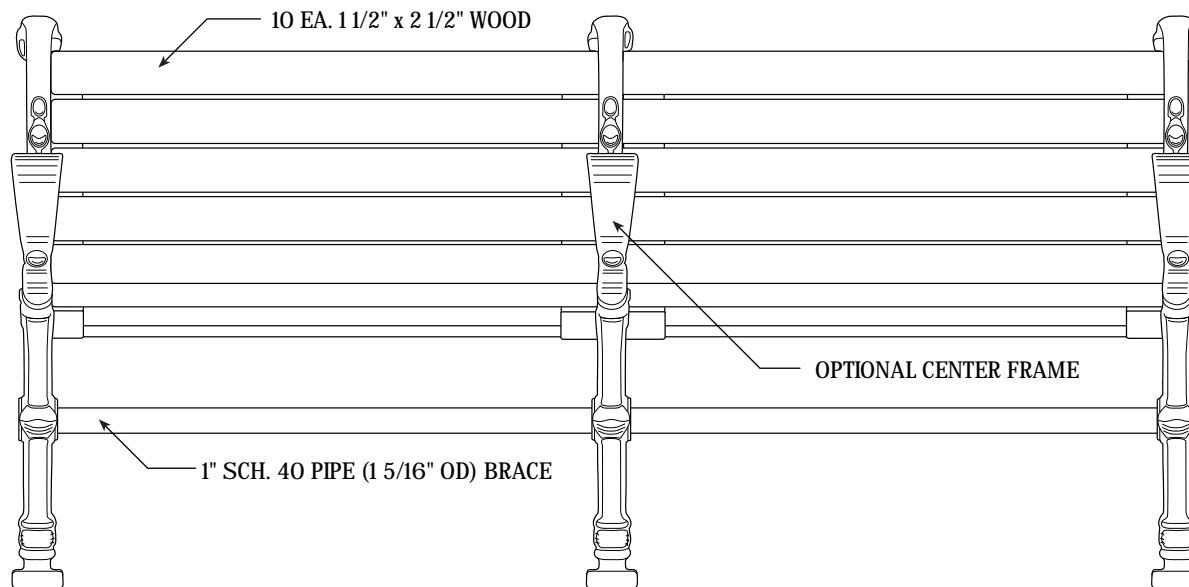
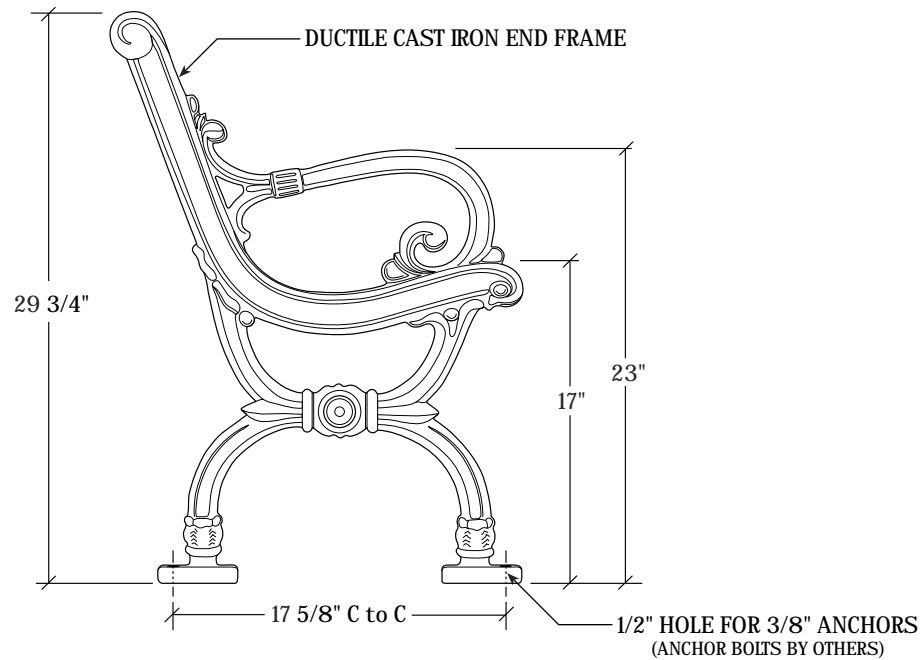

SPECIFICATIONS

MATERIAL

Wood: 10 each 1 1/2" x 2 1/2" wood elements,
All edged eased.

End Frames: Ductile cast iron end frames cast with 1/4" x 2" flange to attach wood elements. Frames shall have an arm rest flared to 2 5/8". Frames shall have a recess for hardware which attaches stretcher bar.

Center strap: 3/8" x 2" mild steel predrilled to accept hardware. All steel shall conform to ASTM A 36 hot rolled steel and shall be wheelabrated prior to fabrication.

Stretcher bar: 1" sch. 40 pipe (1-5/16" OD)

FASTENERS

Wood shall be attached to end frames and center frame with #14 stainless steel vandal resistant screws. Stretcher bar shall be attached to end frame with 3/8" x 1 1/4" SS buttonhead bolts and washers.

Anchor bolts by others.

PROTECTIVE COATINGS

Wood: clear wood preservative

Powder Coating: Following fabrication parts shall be cleaned and treated with an iron phosphate process prior to the coating application. This process shall include a non-chromated alkaline cleaner and an iron phosphate treatment followed with an acidic sealer for maximum adhesion. The protective coatings shall be either polyester or polyester TGIC powder. Following application the parts shall be baked until properly cured. The coating shall be a minimum of 4 mils thick on all surfaces.

OPTIONS

Length: 4, to 8 ft. standard, other lengths available

Wood: Western red cedar, clear vertical grain Douglas fir, Clear all heart redwood, lpe, other species available on request

Recycled Plastic-see TD-3P

Tradition Series, TD-3 Bench with center frame

FairWeather Site Furnishings

360-895-2626 or Toll Free 800-323-1798

Port Orchard, Washington

©1999-2002 Leader International Corporation,
FairWeather Site Furnishings division