

STANDARD PANEL GRAPHICS FOR
PAPER - MAGAZINES
GLASS - BOTTLES
PLASTIC - BOTTLES
ALUMINUM CANS
COMPOST - ORGANICS

OPENING SHAPES FOR RECYCLE/TRASH
1-3/4" x 10" PAPER SLOT
2-3/4" CIRCLE OPENING - ALUMINUM CANS
4-1/4" CIRCLE OPENING - GLASS
5" CIRCLE OPENING - PLASTIC BOTTLES

SPECIFICATIONS

MATERIAL

The TR-20.2 half round recycle container is fabricated in two quarter round sections with a 14 gauge steel frame and a 16 gauge stainless steel door panel with laser cut graphics. The flat top is 11 gauge laser cut steel with trash and/or recycle openings. Base Plate is HDPE
Flat back panels are HDPE

Liners:

7-1/2 gallon quarter round black polyethylene (two)

FASTENERS

Stainless steel assembly hardware
Anchor bolts by others

PROTECTIVE COATINGS

Powder Coating: Following fabrication products shall be cleaned and treated with an iron phosphate process prior to the coating application. This process shall include a non-chromated alkaline cleaner and an iron phosphate treatment followed with an acidic sealer for maximum adhesion. The protective coatings shall be either polyester or polyester TGIC powder. Following application the parts shall be baked until properly cured. The coating shall be a minimum of 4 mils thick on all surfaces. Zinc Rich corrosion resistant undercoat is required.

OPTIONS

Disposal opening shapes for recycle or trash use
Panel graphics
Bag hangers

TR-20.2 Multi-Cycle Receptacle, Half Round Solo Unit with two Quarter Rounds

FairWeather Site Furnishings

360-895-2626 or Toll Free 800-323-1798

Port Orchard, Washington

©1999-2016 Leader International Corporation, FairWeather Site Furnishings division
Notice: These products are proprietary. Numerous designs are patented or patent pending under Leader Manufacturing, Inc.

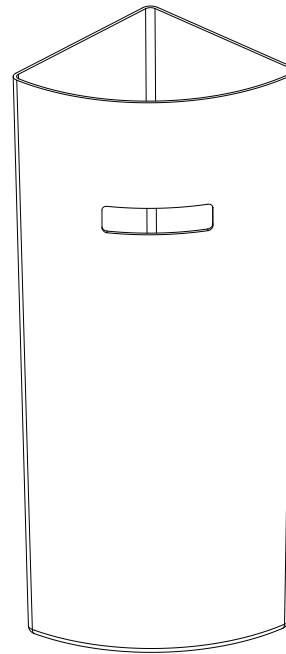
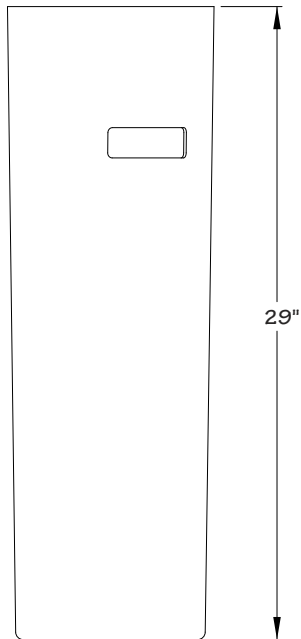
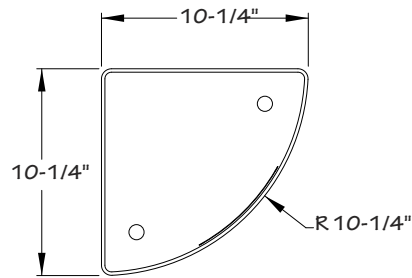

QUARTER LINER
7-1/2 GALLON CAPACITY
10-1/4" X 10-1/4" X 29" TALL

SPECIFICATIONS

MATERIAL

Linear low density black polyethylene with UVB protection
.170 wall thickness
7-1/2 gallon capacity

Note: The 7-1/2 gallon quarter liner is a standard component of the following trash and/or recycle containers:

TR-20.2
TR-20.4

REV 04-11-16

7-1/2 Gallon Polyethylene Trash/Recycle Receptacle Liner

FairWeather Site Furnishings

360-895-2626 or Toll Free 800-323-1798
Port Orchard, Washington

©1999-2016 Leader International Corporation, FairWeather Site Furnishings division
Notice: These products are proprietary. Numerous designs are patented or patent pending under Leader Manufacturing, Inc.